

HUNTERS®

HERE TO GET *you* THERE

5 Stansfield Close, Bradford, West Yorkshire, BD10 0EN

Asking Price £280,000

Property Images



Property Images



Floorplan

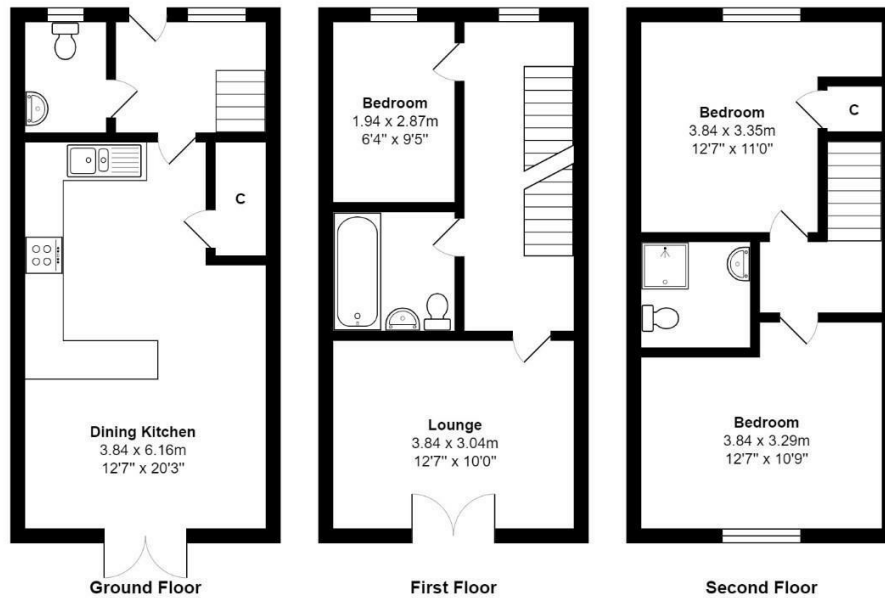

Total Area: 93.1 m² ... 1002 ft²

All measurements are approximate and for display purposes only

EPC

Energy Efficiency Rating		
	Current	Potential
Very energy efficient - lower running costs		
(92 plus) A		95
(81-91) B	84	
(69-80) C		
(55-68) D		
(39-54) E		
(21-38) F		
(1-20) G		
Not energy efficient - higher running costs		
England & Wales EU Directive 2002/91/EC		

Map

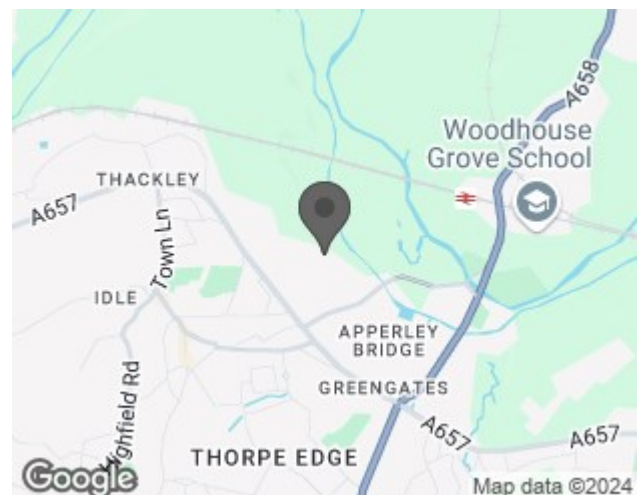

Details

Type: House - Townhouse Beds: 3 Bathrooms: 3 Reception: 2 Tenure: Freehold

Summary

This luxurious modern townhouse, located in a sought-after development, offers stunning open views of the fields at the rear and sits in a peaceful cul-de-sac. Featuring high-quality fixtures and finishes throughout, this property is a fantastic opportunity for those seeking a stylish and comfortable family home.

The spacious accommodation is thoughtfully designed, beginning with an entrance hallway leading to a guest WC and an impressive open-plan living kitchen. The kitchen includes a breakfast bar and French doors that open onto the enclosed rear garden, perfect for indoor-outdoor living. On the first floor, you'll find a bright lounge offering lovely valley views, the main family bathroom, and the third bedroom. The second floor houses the master bedroom, complete with an ensuite and Juliet balcony, alongside the second bedroom.

Externally, the property offers convenient off-street parking for two vehicles, including an electric car charging point. The rear garden is laid to lawn and fully enclosed with fenced boundaries, providing a safe space for families to relax and play.

Features

• MODERN TOWNHOUSE • STUNNING VALLEY VIEWS • SOUGHT AFTER DEVELOPMENT • LOUNGE WITH JULIET STYLE BALCONY • OPEN PLAN LIVING KITCHEN • REMAINDER OF BUILDERS GUARANTEE • GUEST WC • TWO PARKING SPACES WITH CHARGING POINT • ENSUITE TO MASTER • HUNTERS 360 TOUR